

27

map number

124 Ashmore Circle,
Troutman

- Extensive trim package
- Large kitchen pantry
- Elegant stone fireplace in FR
- Distinctive Hickory floors
- Extremely spacious three-car garage
- Media room - Great for entertaining
- Beautiful covered porch leading to private yard with fire pit

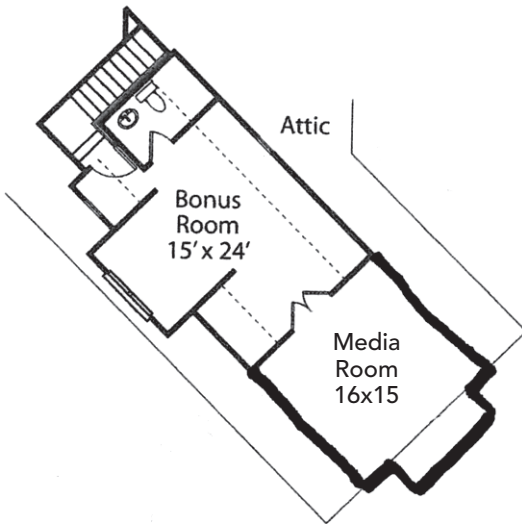

\$579,300

Directions

I-77 N to exit 36. Left onto Hwy. 150 W. 5 miles, take right onto Perth Rd. 5 miles, take right into Falls Cove (Streamwood Rd.) 2nd left onto Ashmore Circle. House on corner of Ashmore Circle and Ashmore Circle.

Partners

- Pella Window & Door Co.
- ABC Supply Co.
- Lee Lighting
- Mullis Garage Door Service
- Aspen Tops, Inc.

Strom Construction, Inc.

www.stromconstructioninc.com ■ 828-478-9460